



ArchDaily Projects Housing France Agence Bernard Bühler 2017 FULTON – A5 A1 / Agence Bernard Bühler

FULTON – A5 A1 / Agence Bernard Bühler

13:00 - 20 June, 2017

[Share in Whatsapp](#)



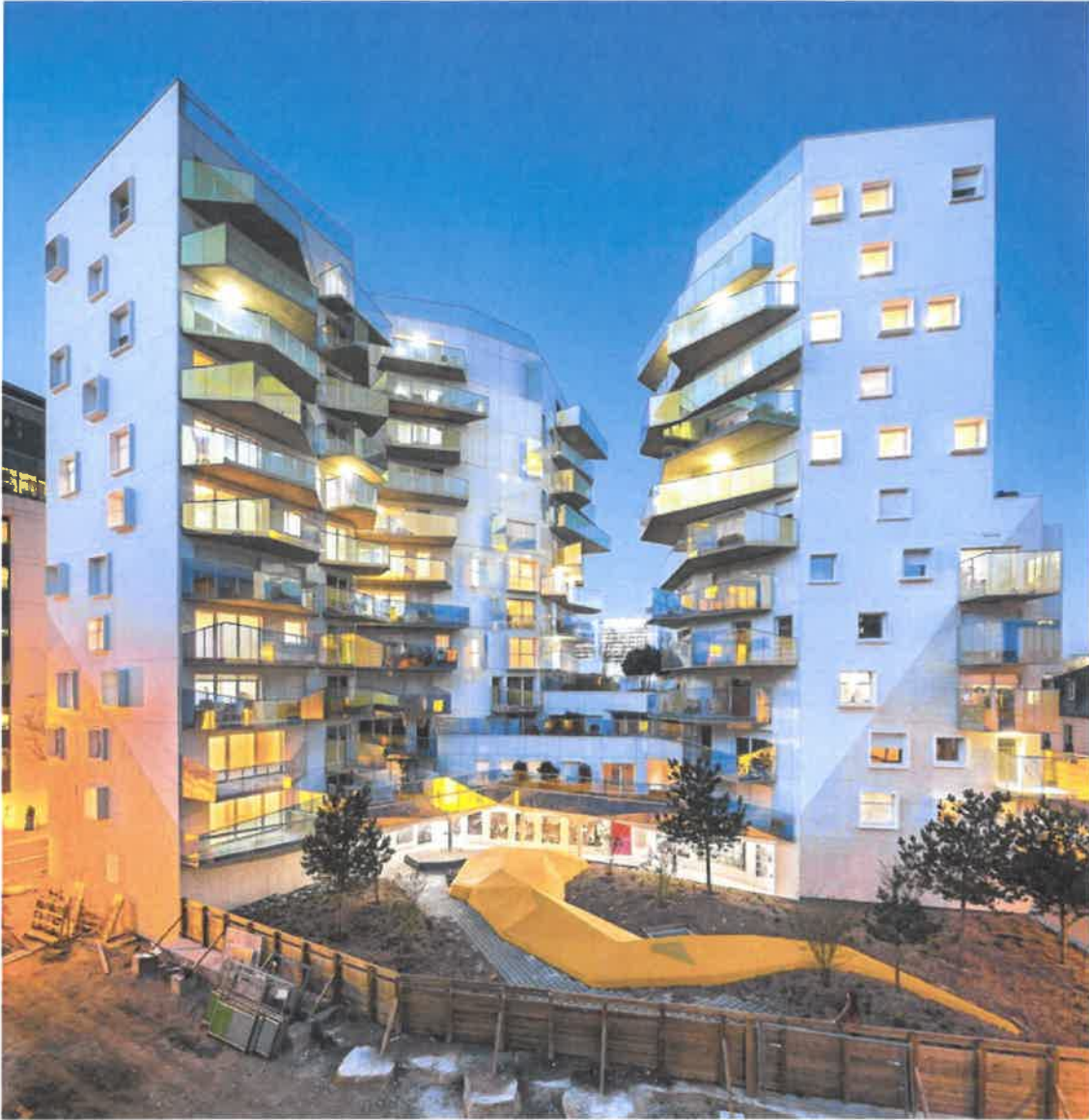

Text description provided by the architects. ICF La Sablière owns the Fulton block, located in the 13th arrondissement of Paris, on the banks of the Seine. The existing real estate complex known as "Fulton" was built in the 1950s by architect Daniel Michelin and is occupied by 133 dwellings. The site benefits from a very beautiful location, clear, in front of the Seine, near the bridge of Bercy in the East and the museum of fashion and design at the West, a contemporary building realized by the architects Jakob + Macfarlane.



The building is located on the Quai d'Austerlitz and marks the corner of Fulton and Bellière streets. The operation comprises 87 social housing units, 2 shops on the ground floor, 30 parking spaces in the basement and a garden in the heart of the lot.

The garden marks between the two towers a breach enter the East / West, based on the urban study, and is extended by a set of terraces until the RDC.

